



The 1st Three Months
September - November 2017

Impact Hub Honolulu is a coworking, event, office, and community space designed to facilitate sustainable impact in Hawaii and abroad through collaboration and empowering communities.

Soft Opening August 23, 2017
Free until September 01

Coworking Plans

(non-office plans, coworking only)

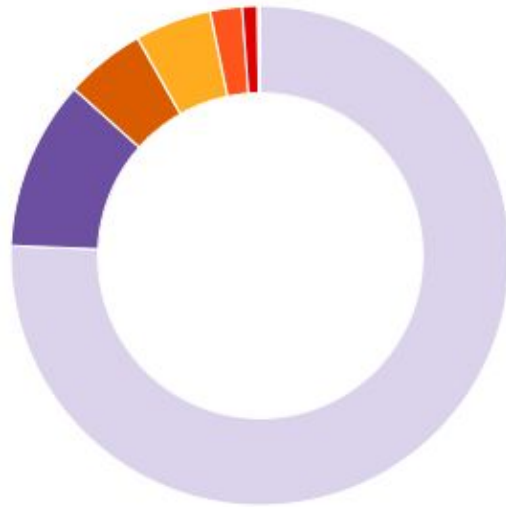

- 3 - Unlimited
- 1 - Part-Time
- 2 - Starter
- Mail Service
- Unreserved Parking Space
- Small Lockers
- Public Static IP Address
- Crowdfunding Perk: Part-time membership
- Crowdfunding Perk: Starter membership
- Crowdfunding Perk: Unlimited Plan
- Other

Users on plans ⓘ

93

Revenue from plans ⓘ

\$6,057.42

- 62 Coworking Memberships
- 11 Host Memberships
- 7 ImpactARTists
- 14 plans for amenities (mail service, lockers, parking, static IP address)
- **\$6057** Monthly Revenues

Total Impact Hub HNL App Downloads

Users over time ⓘ

Track the growth of your organization's user population.

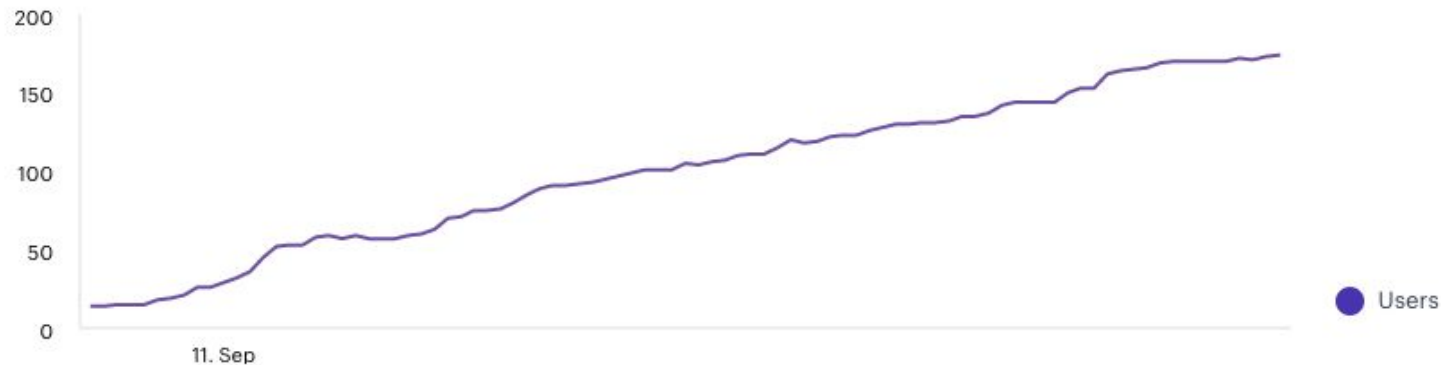

123

Users ⓘ

0%

192

New users ⓘ

+735%

93

Users on plans ⓘ

0%

24

Total teams ⓘ

0%

Offices

28 offices - 2500sf

0% Vacancy

\$18,887 Monthly Revenue

100% Rental Furniture Inventory Used

16 Serious Potential Tenants on Wait-list

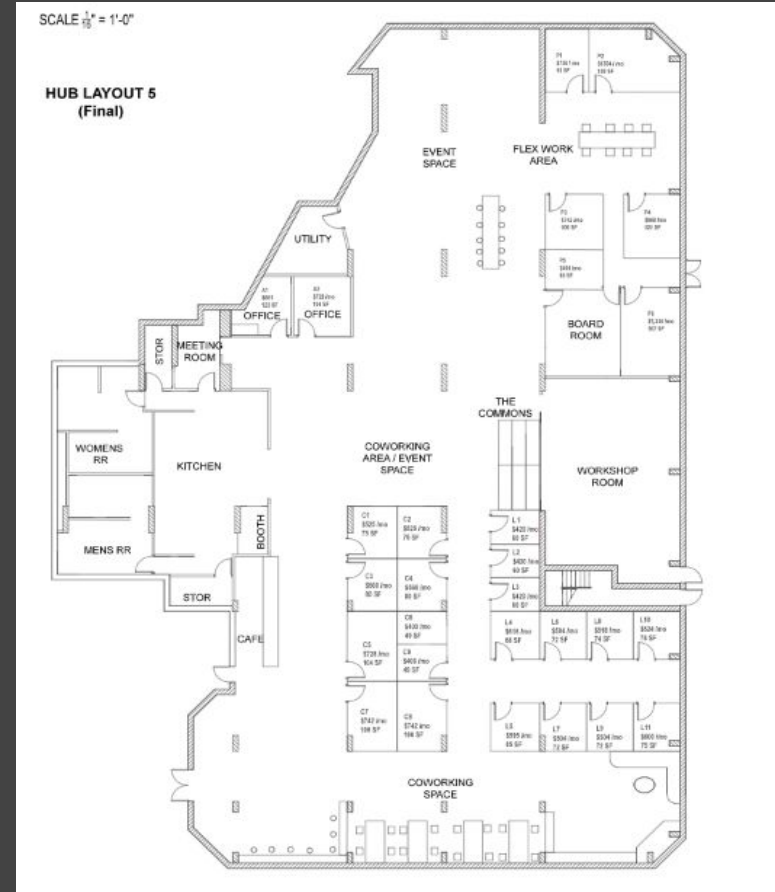

Meeting Room Bookings

Booked vs. available ⓘ

*Based on 24/7 availability.

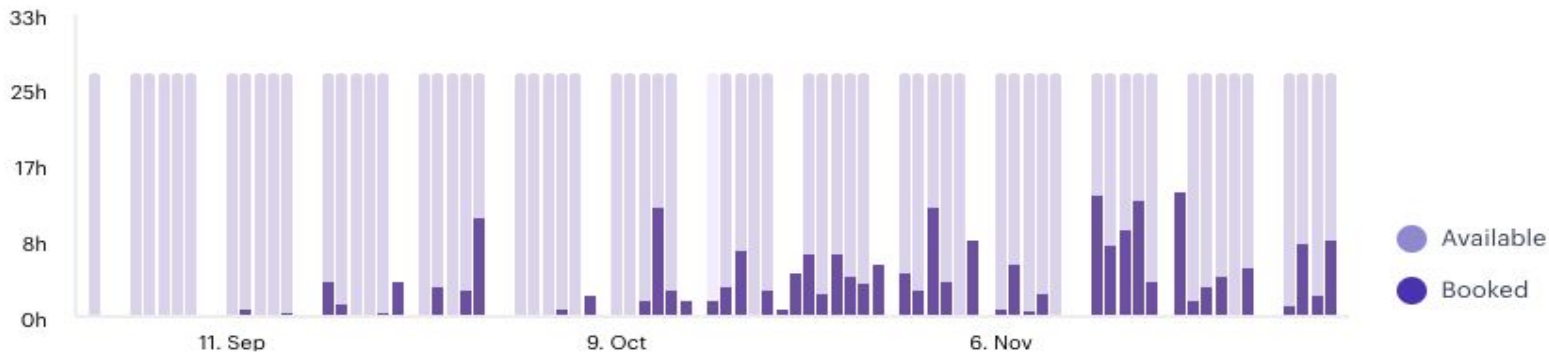

115

Bookings ⓘ

+1338%

246h 15m

Booked ⓘ

+3418%

14%

Booked ⓘ



+3407%

2h 6m

Avg. Duration ⓘ

+139%

Meeting Room Bookings (by room)

	Name	Bookings ▾	Hours booked	% Booked	Avg. duration
	Small Meeting Room Meeting Room	67	87h 15m	15% (+1348%)	1h 18m
	Workshop/Training Room Meeting Room	31	122h 15m	21% (+12194%)	3h 42m
	Board Room Meeting Room	17	36h 45m	6% (+100%)	2h 9m

*Percentages based on 24/7 availability.

Event Revenues

- \$10,790.42+
- 45 total events
- 12 event scholarships
- 2500+ event attendees



Weekly Newsletter

Current Audience Size: 2,102

Average Views per week: 654

Growth since July 2017:

- Doubled our click rate
- Quadrupled our share rate
- 31% growth in unique views



The image shows a screenshot of an email newsletter from Impact Hub Honolulu. At the top left is the Impact Hub Honolulu logo. Below it is a large photograph of a group of people sitting on colorful beanbag chairs in a bright, modern meeting space with large windows. Below the photo is another instance of the Impact Hub Honolulu logo. Underneath the logo is the heading "FEATURED EVENT!" in red. Below this is a promotional graphic for an event titled "Art of Hosting: Facilitating Hawaii's New Edge". The graphic features abstract blue and orange colors and includes the text "ART OF HOSTING", "FACILITATING HAWAII'S NEW EDGE", and "DEC 7-9, 2017". To the right of the graphic, the event details are listed: "Art of Hosting: Facilitating Hawaii's New Edge" and "Thursday-Saturday, 12/7-9, from 8:30-12:00".

IMPACT HUB Honolulu

IMPACT HUB Honolulu

FEATURED EVENT!

Art of Hosting: Facilitating Hawaii's New Edge

Thursday-Saturday, 12/7-9, from 8:30-12:00

FOUNDING PARTNER CIRCLE



\$79,400 Founding Partner
Circle Contributions
\$4,743.43 used towards
events so far